

PRESENTATIONS

1. Permeable Pavers: A Discussion
2. NIPC Evanston

Permeable Pavers: A Discussion

James C. Gamble, RLA, ASLA

Thompson Dyke & Associates, Ltd.



Advanced Pavement Technology Partners' Meeting August 5, 2009

Example Permeable Pavers



- Parking Lots
- Walkways
- Plazas
- Alleys



Example Permeable Pavers



- Concrete
- Natural Stone
- Clay Brick
- Face Mix

Paving the Way to A New Buckingham Fountain: A Case Study

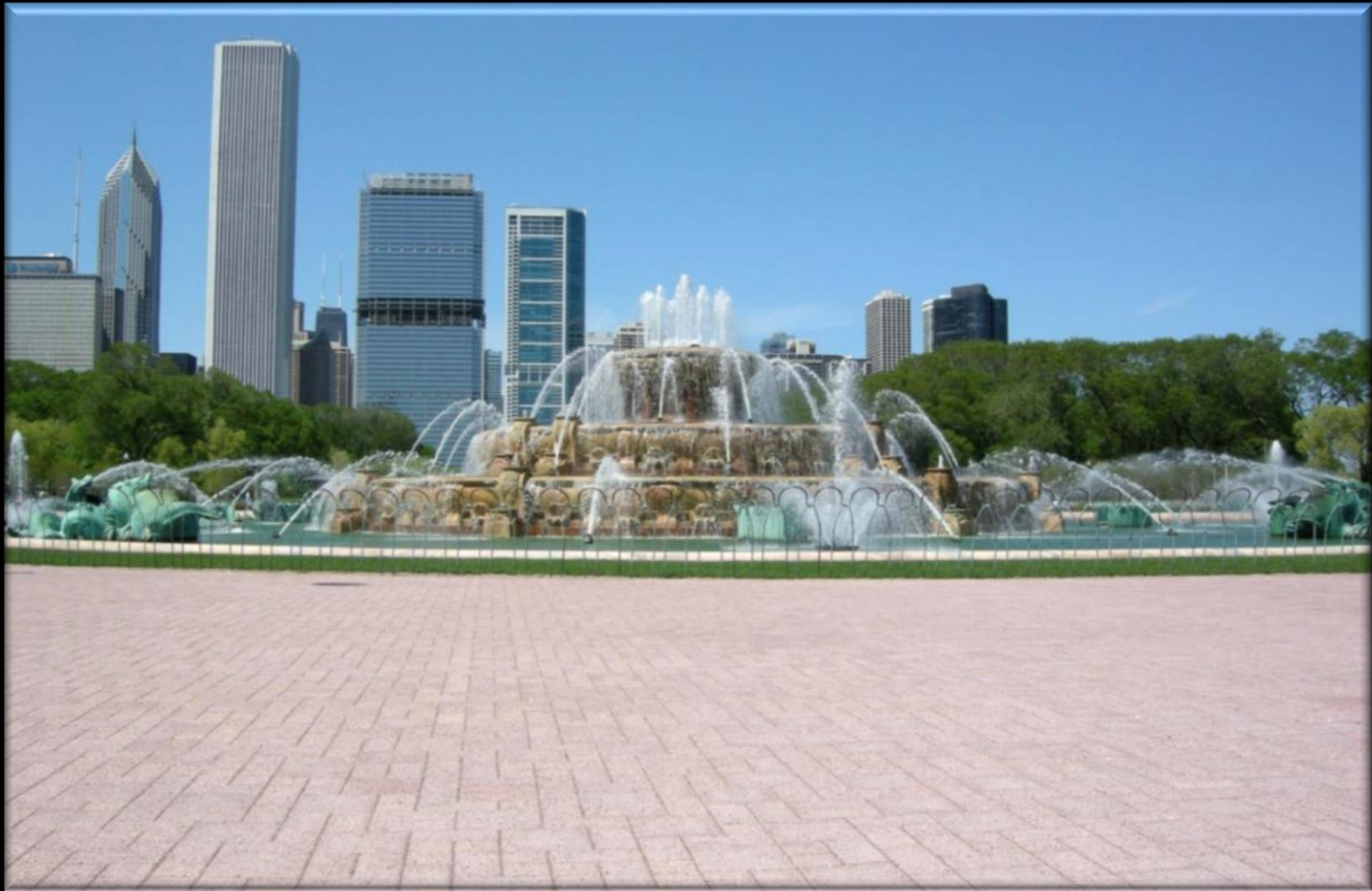

Just the Facts

Project Scope:

Comprehensive restoration of
the fountain and surrounding site

Clients:

Chicago Park District
The Art Institute of Chicago

Budget:

\$25 million

Location:

Chicago, IL

Paver Field Size:

285,000 sq. ft. (6.54 acres)

Detention Capacity:

85,000 cubic ft.

Ph. I - II Construction Dates:

Sept. 2008 – April 1, 2009

Anticipated Completion:

May 2010 Ph. III - IV

Buckingham Fountain Master Plan

BUCKINGHAM FOUNTAIN - RENOVATION

MASTER PLAN

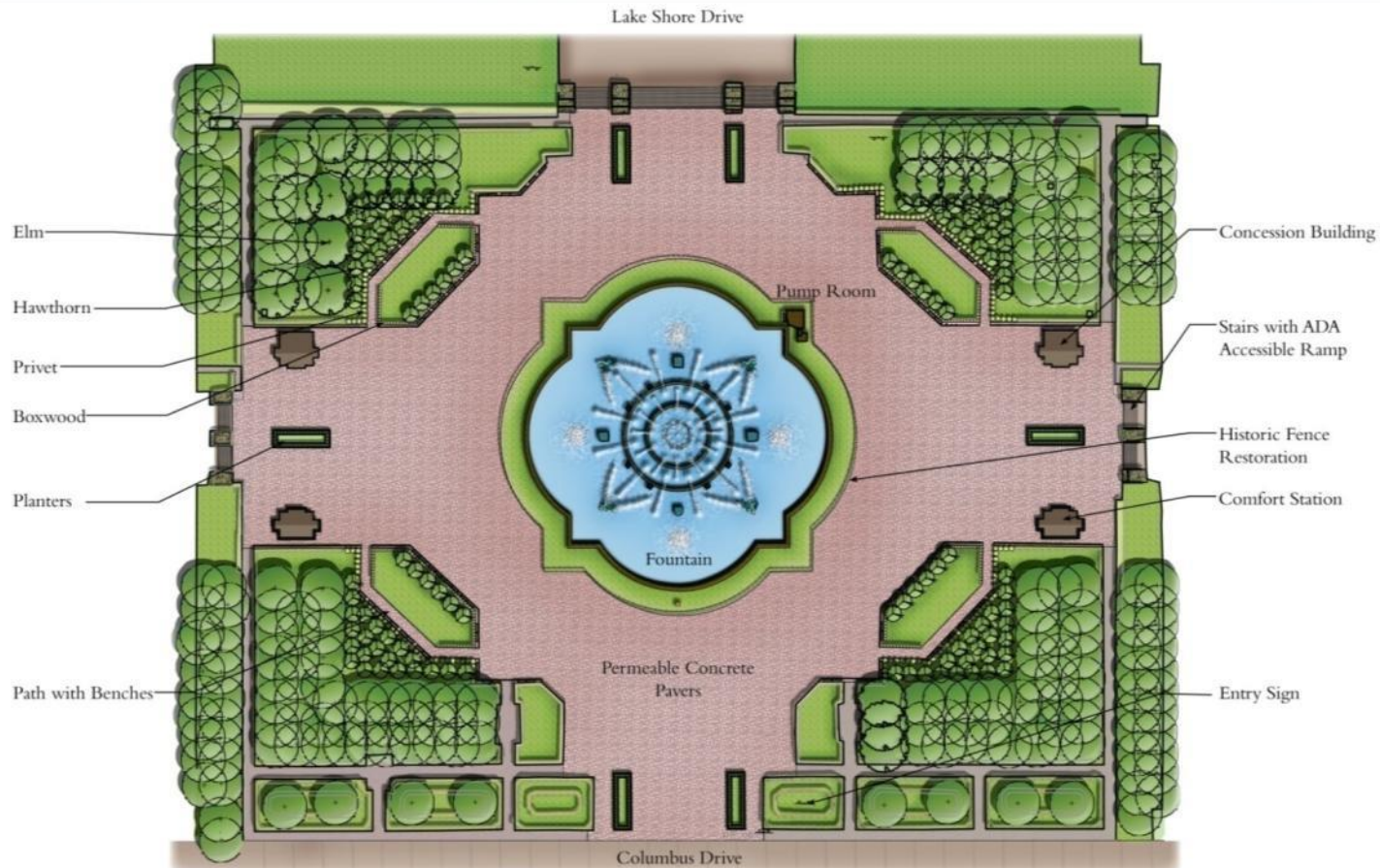

Permeable Paving Pattern – 49 Pavers

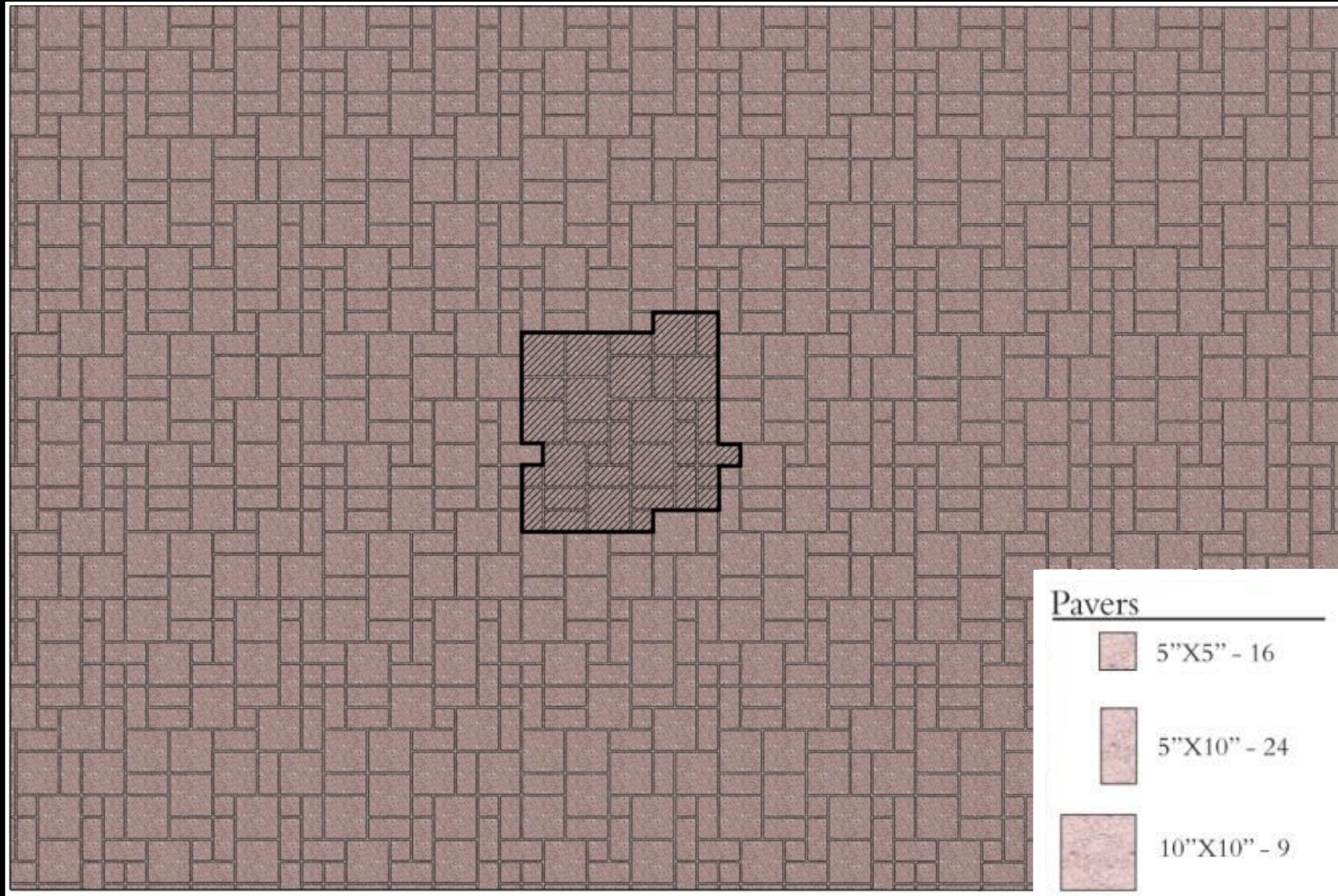

Program: The Three A's

*Mayor's Office for
People with
Disabilities*

Accessibility

*City of Chicago
Landmarks Commission*

Appearance

*City of Chicago
Dept. of Water Mgt.*

Absorption

Accessibility



Requirements:

- ADA Accessible
- Smaller Gap
- Railing-Free Ramps

Uses:

- Disabled Visitors
- Service/Maintenance Vehicles
- Security
- Tourists

Appearance

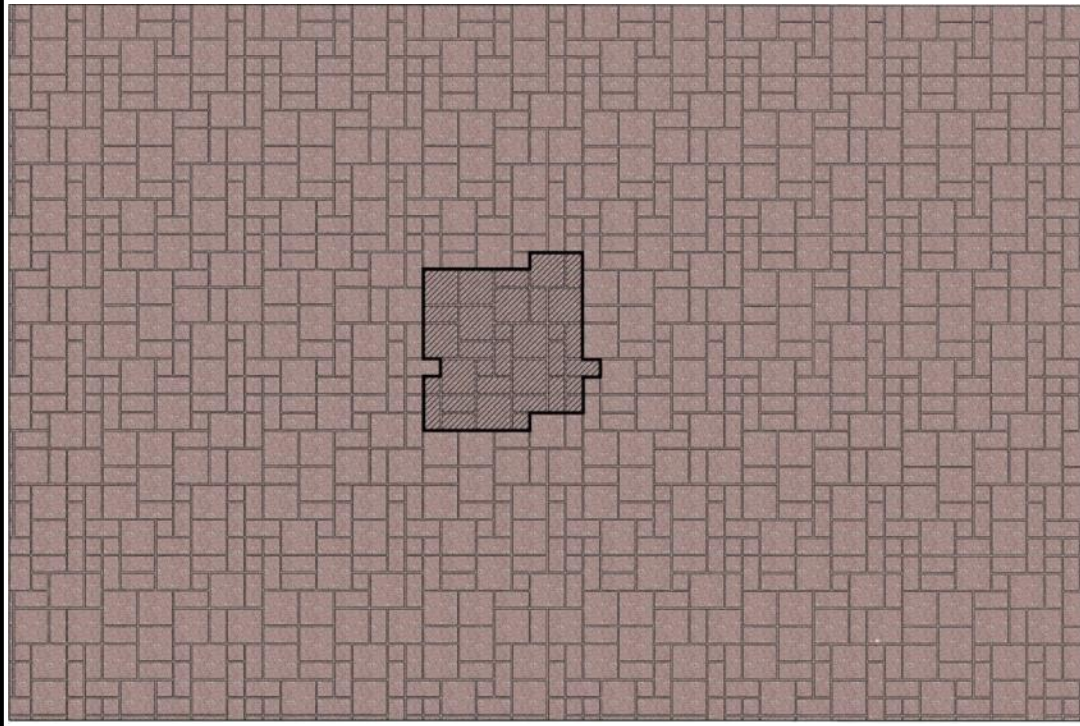

Requirements:

- No pattern
- Historically significant “pink stone” look
- Natural

Uses:

- Improved Aesthetics
- Historically-Sensitive Treatment

Appearance



Absorption



Before

No stormwater infrastructure



After

85,000 ft. of stormwater detention

Unique Challenges

Historic
Renovation

Pavers &
Fence

Deadline;
Winter
Construction

Unique Challenges: Pavers



Quality Control:

- Surface
- Size
- Uniformity
- Cleanable

Construction

Challenges:

- Installation Sequence
- Fence Protection
- Soil Stabilizer Fabric
- Underdrains
- Existing Subgrade



Winter Construction



Due to sub-zero temperatures, the contractor had to use heaters and blankets in order to eliminate sub-grade frost for the installation of the paver field during the winter.

Unique Challenges: Fence



Before



After

Fence Inventory Plan

CHICAGO
MIRK
DISTRICT
come out
and play

BUCKINGHAM FOUNTAIN

FENCE INVENTORY

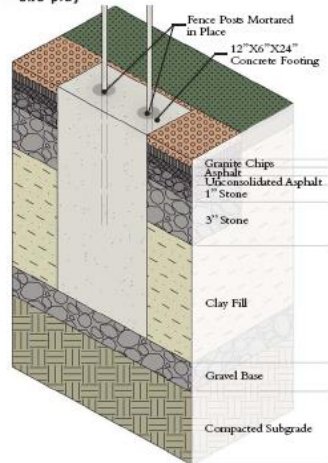

Typical Concrete Fence Footing
Scale: NTS

Legend

- Exposed Footing w/ Number of Occurrences
- Damaged/Missing Fence Clip w/ Number of Occurrences
- Fence Loops that Require Repair
- Corresponding Picture Number

Totals:

Damaged/Missing Clips: 25

Exposed Footings: 230

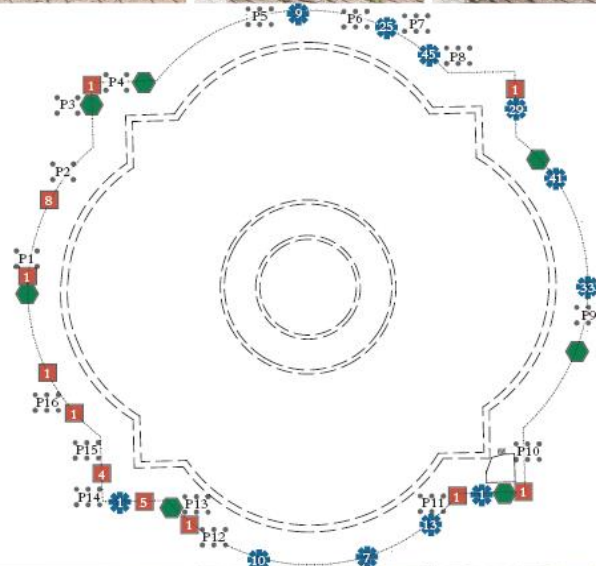

Political Impact

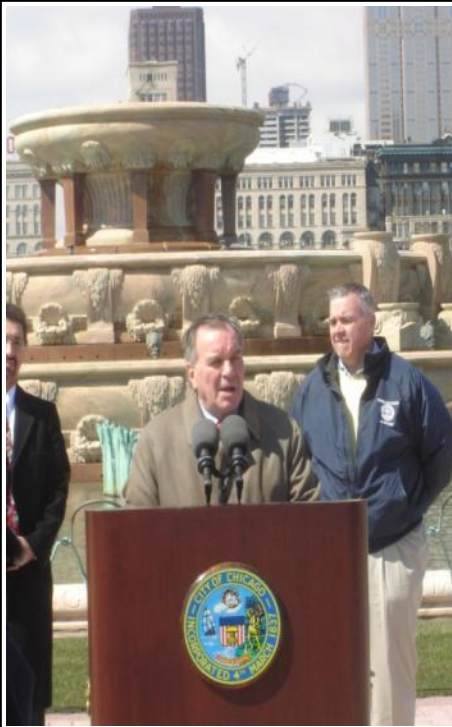

- City of Chicago
- Chicago Park District
- Art Institute of Chicago
- General Public

Public Impact

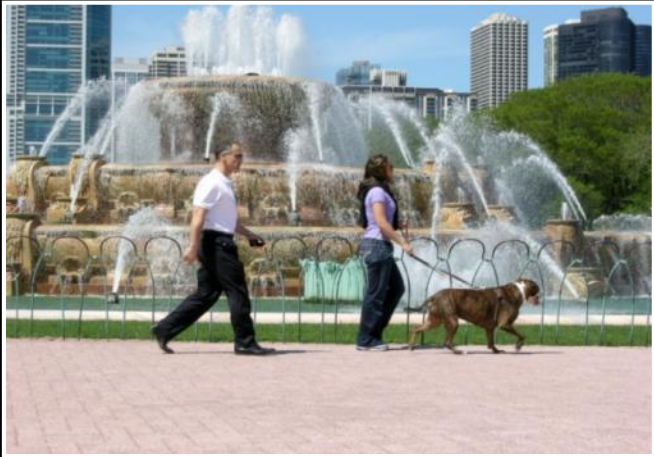

- Visual City Icon
- Tourist Attraction
- Hub for City Festivals & Events
- Source of Civic Pride







Questions?

NIPC Evanston



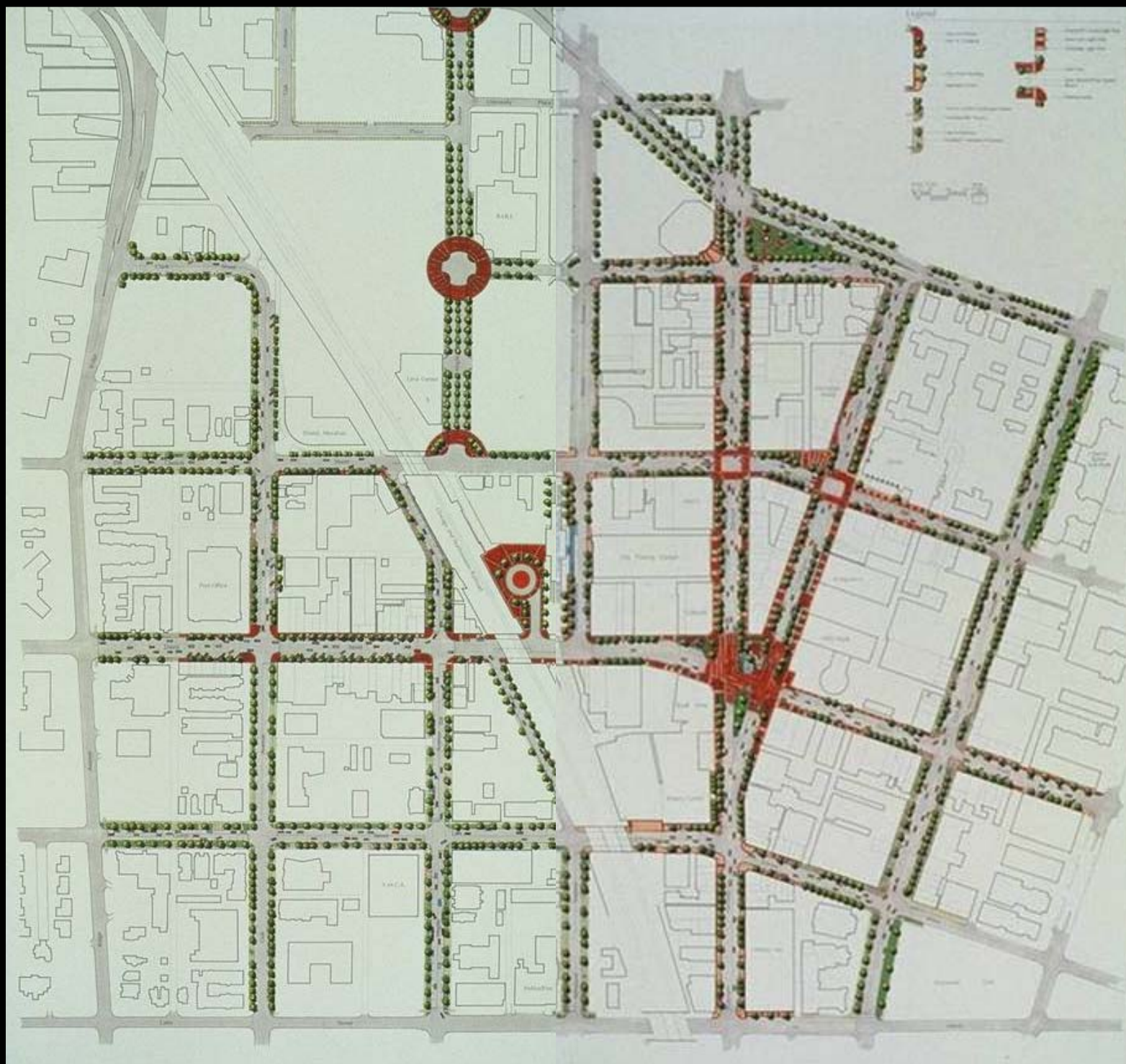



















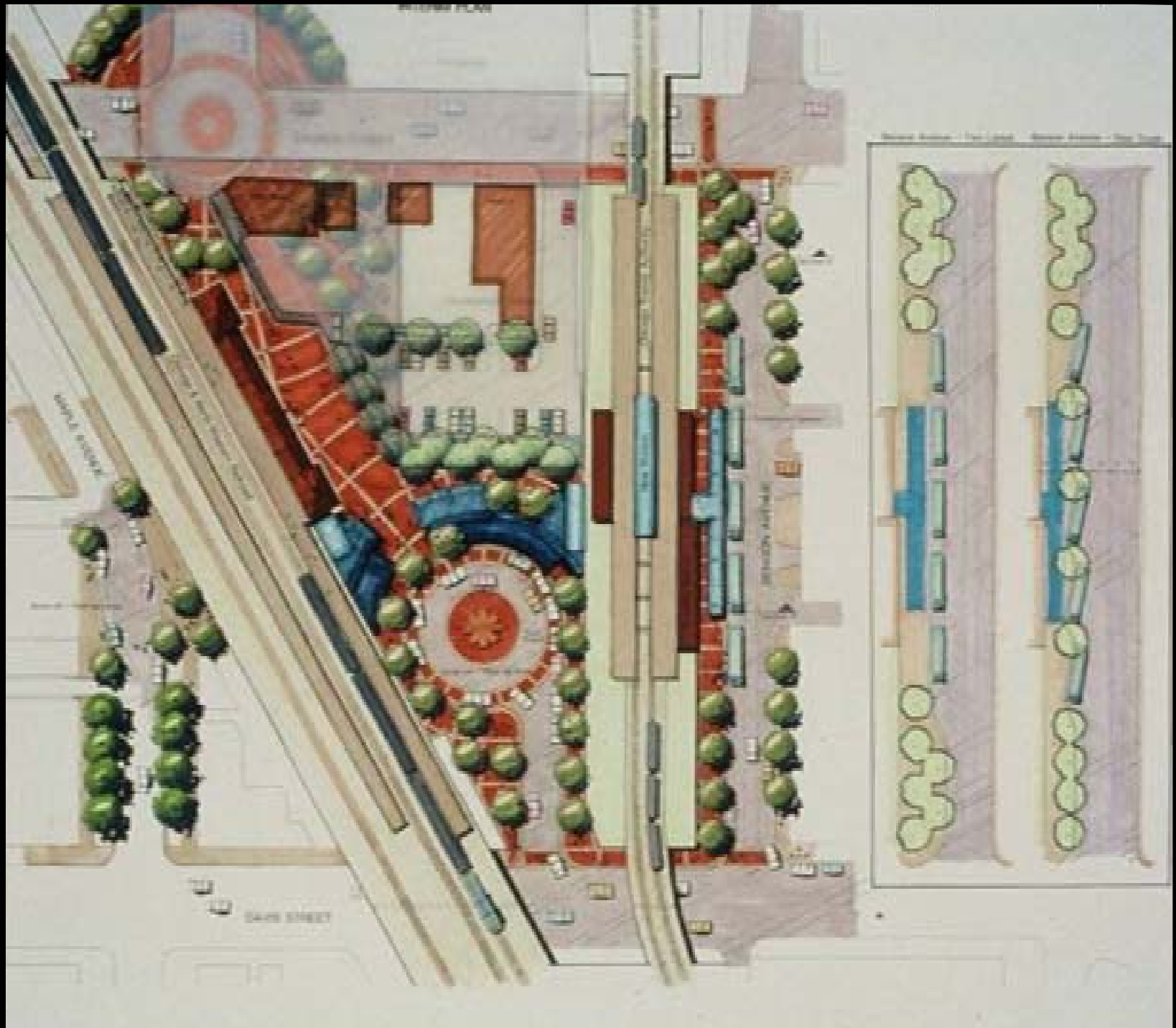

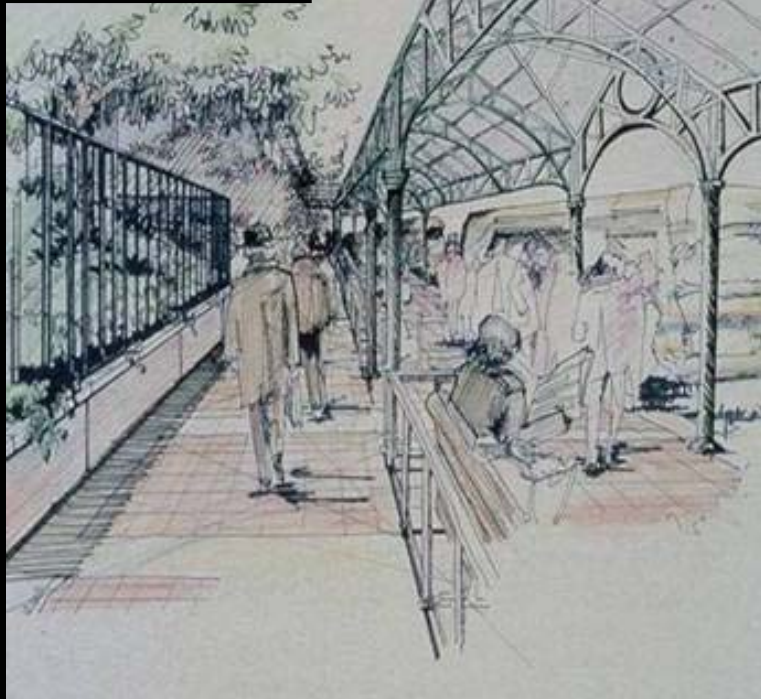











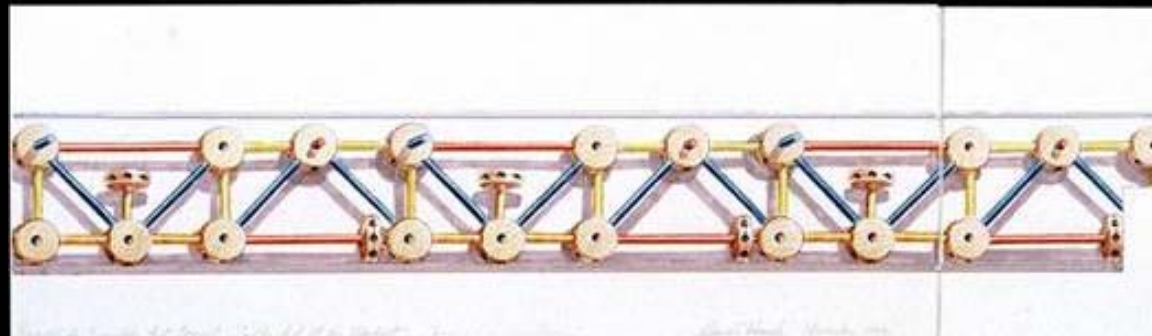
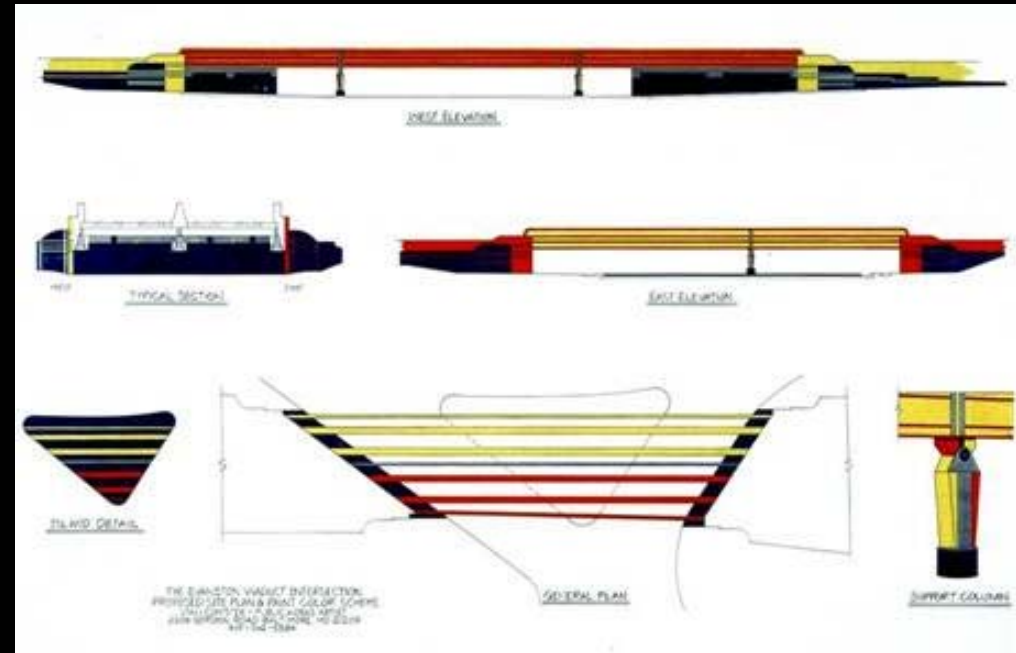



© 1986- 2019 Material Presented in this Booklet is
Property of Land Design Collaborative. All Rights Reserved.